

Cupertino ARES/RACES First Look Exercise Review

December 3, 2020
Jim Oberhofer KN6PE





#5

FIRST LOOK EXERCISE REVIEW

2020 Pandemic + First Look Area Exercise

14 Nov 2020

Objectives

1. Execute the response per the CCC Infectious Disease Response (IDR) Plan protocols
2. Perform the First Look Area assessment
3. Report First Look Area findings to the DOC and DPW



FLA – by the numbers

Total FLA Assessments made:	20 out of 33 areas
Average time per FLA:	37 minutes
Ave reported miles per FLA:	6
Average Speed:	10.8 mph
CARES Participants:	18
Field teams w/ household-buddies:	7
Responders going solo:	5



Key Findings

- 1. *Infectious disease response plan.*** The IDR plan worked well with 7 of the 12 field teams using a household non-CARES 'buddy' to participate in the field exercise. Additionally, 5 members agreed to go 'solo'. FYI...
 - 20 CARES members identified a household-buddy.
 - 21 CARES members stated their willingness to accept a solo assignment.
- 2. *First Look Area Assessment Process.*** Twelve (12) field teams completed 20 of the 33 defined *First Look Areas* over a 2-hour period. With this level of staffing, it is plausible that the entire city could be checked in about a 3-hours.



Tracking FLA assignments at C469

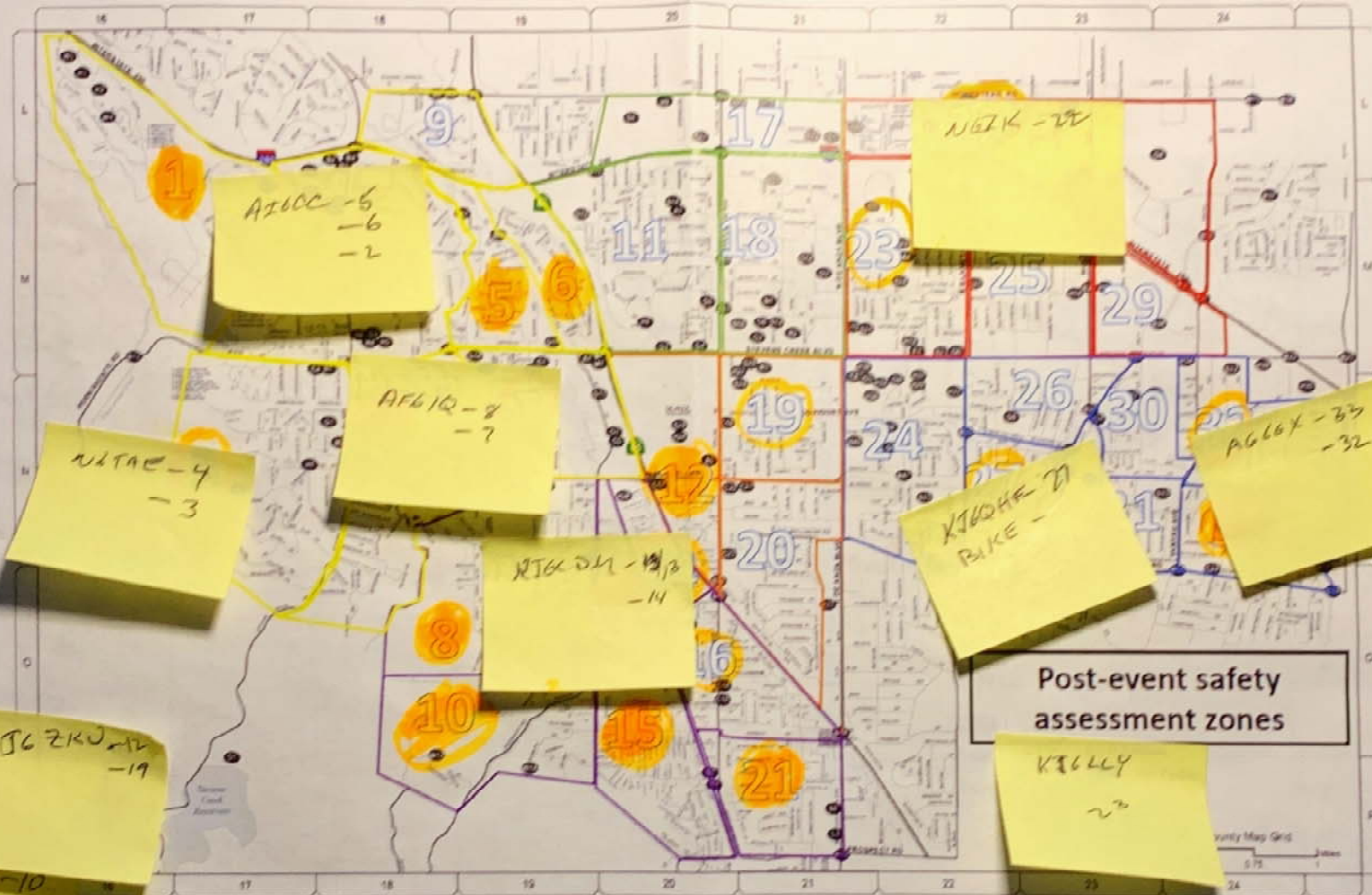

Tracking FLA assignments in the field

2.4 Zone 1 / Areas 5, 6

Name: [REDACTED]	Activation #: CUP-20-40T	Date: 11/14/20
Assigned Area: 5, 6		
Time/Start: 0914	Stop: 0939	Odometer/Start: (last 3 digits) 436
AS 0946	AB 0937	Stop: 440
		442

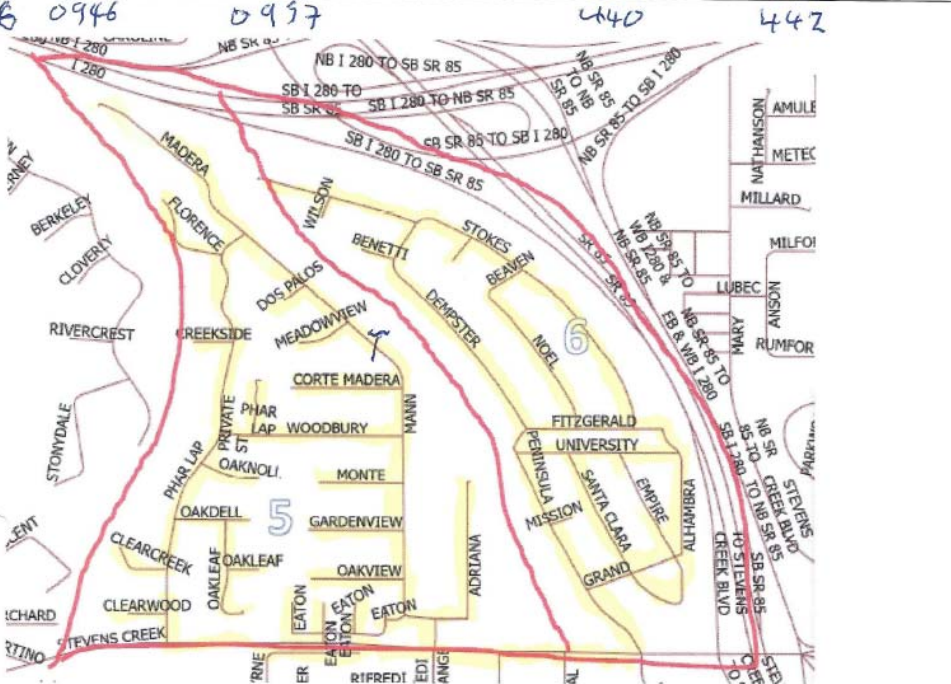

Notes, Problems
 TREE BLOCKING RD 10310 MIAMI DR - AREA 5

2.7 Zone 2 / Area 8

Name: [REDACTED]	Activation #: CUP-20-40T	Date: 11/14/2020
Assigned Area:		
Time/Start: 0928	Stop: 10:10	Odometer/Start: (last 3 digits) 017
		Stop: 027

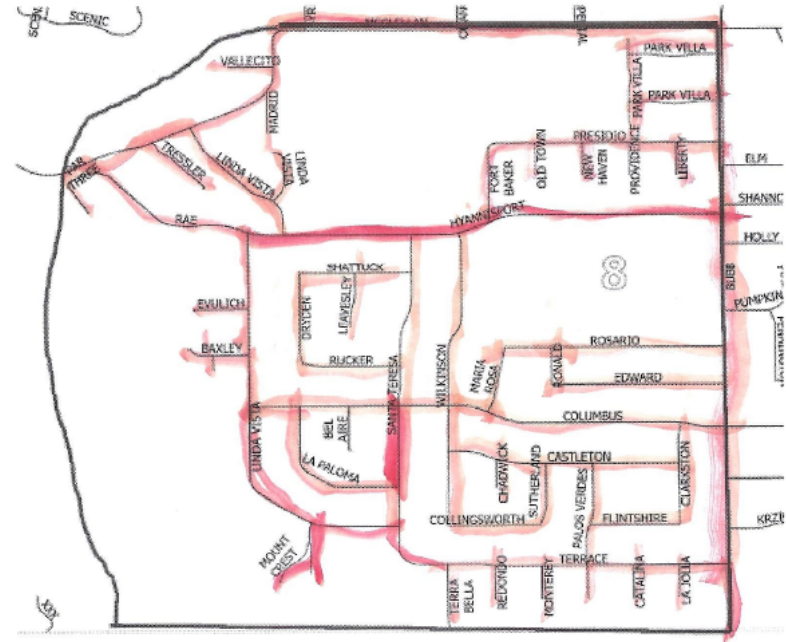

Notes, Problems
 0939 - CAR OIL LIGHT
 0942 - @ HOME - OIL CHG 208
 0947 - ON ROAD - OIL 219 (1.1mi)
 0951 BACK AT RAE/LINDAVISTA



Observation #1

The First Look Area Assessment process essentially worked as intended.

CARES covered roughly 100 mi of streets in a 2-hour period. While not perfect, this process works sufficiently as is such that it could be deployed now if required.

Recommendations

1. Review these findings with Cupertino DPW to confirm their interest in the FLA Assessment.
2. Process refinement -- data collection, maps, procedures, expectations, info handoff to DPW, EOC
3. Develop a two-pass approach to first cover Arterials and Major Collectors, and then Minor Collectors, Neighborhood Collectors, and Neighborhood streets.
4. Introduce *First Look* to CERT and Block Leaders. Work with CCC Coordinator on a field exercise in 2021.



Observation #2

How does First Look fit with other assessments that CCC has developed?

1. What we do today...
 - a) Mike-Mike roll-up, CARES
 - b) Preliminary Safety Assessment, CARES
 - c) Neighborhood PSA, CERT
 - d) Infrastructure Safety Assessment, CARES
 - e) Rapid Needs Assessment, CCC
 - f) First Look Area Assessment, CCC

Recommendations

1. Develop a profile for each type of assessment that CCC performs including: scope, staffing, time to run, information provided, and recipient.
2. Develop an activity timeline and criteria that describes when a specific assessment should be initiated.
3. Consider integrating street-level ISA assets into First Look.



Observation #3

Our deployment depends on the number of available resources. The priority to staff various assignments needs to be set with consideration for the needs of the community.

1. Adding the FLA Assessment to the CARES task essentially places an additional resource load on the organization, on top of ISA, ARK Level 2, Alt911, Fire Stations, C469 support, and other ad-hoc mission requests.

Recommendations

1. Develop the assignment order for deploying resources given a task's priorities and number of responders available during an activation.



Observation #4

We tend to staff our exercises for the best-case resource scenario that requires a full EOC and Field deployment. Like this exercise, a smaller management infrastructure could have worked.

1. We run our exercises assuming: (i) all CARES members are not impacted, (ii) we have enough members covering all assignments with others waiting for an assignment, (iii) we have a continuous message passing load, and (iv) we staff the EOC and C469 to manage all of the above.
2. In short, its all about maximizing training.

Recommendations

1. Review the types of message CARES passes (PSA, ISA, FLA, ICS213, etc.) and the resource requirements for handling each type.
2. Develop the activity trigger levels for adding C469 staffing.



Next Steps

1. Review First Look Area Assessment exercise outcome with DPW... still interested?... CARES, DPW
2. Reconcile the different assessments... CCC
3. Develop the CARES staffing priority... CARES



Thank you

Any Questions?



